

DISCLAIMER:

This unrecorded Record of Survey was donated to the City of Tucson. The City of Tucson provides this data for your personal use "as is." Additionally, the City of Tucson provides this information with the understanding that it is not guaranteed to be accurate, correct or complete and conclusions drawn from such information are the responsibility of the user.

FD 2" BRASS PLUG IN CONC

LAS PALMAS DRIVE

N 89° 40' 50" W * 1432.92 M 1433.93 R

194.90 M 195.0 R
FD 1" L.C.P.
N.W. COR LOT 36

194.90 M 195.0 R

58.89 M 58.93 R
FD 1/2" PIN

36

N 0° 11' 39" E 184.94 (M)
N 0° 19' 10" E 185.06 (R)

37

38

S 0° 19' 10" W 185.12 R
S 0° 14' 08" W 185.00 M

15' UTILITY ESMT

N 89° 39' 45" E 195.0 (R)
N 89° 39' 38" W 194.83 (M)

FD 1/2" PIN

NORTHERN HILLS EST.
(BK 11 PAGE 45 M & P)

15' UTILITY ESMT

FD 1" L.C.P.
FD 2" L.C.P. 0.4 WEST
0.3 NORTH

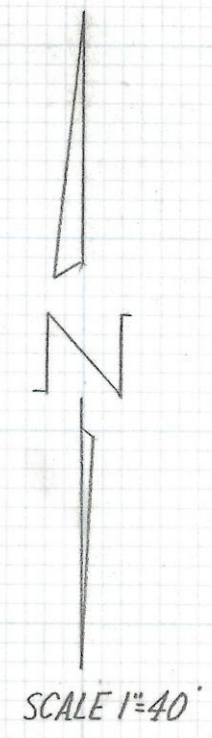

NOTES

- (1) * INDICATES SET 1/2" PIN MKD L.S. 4680 UNLESS NOTED
- (2) M - MEASURED
- (3) R - MAP OR DEED RECORD
- (4) * BASIS OF BEARINGS N 89° 40' 50" W CENTERLINE LAS PALMAS DR. ORACLE FOOTHILLS EST #5 BOOK 16 PAGE 28 M & P

RESULTS OF SURVEY

OF LOT 37 ORACLE FOOTHILLS ESTATES N°5 RECORDED IN BOOK 16 OF MAPS AND PLATS AT PAGE 28 IN THE OFFICE OF THE PIMA COUNTY RECORDER PIMA COUNTY ARIZONA

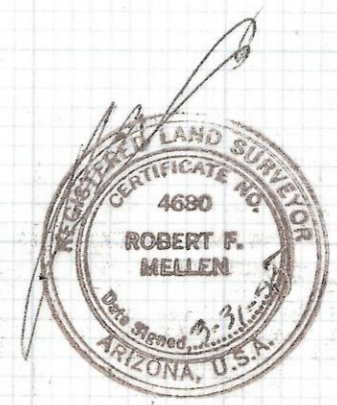

ROBERT F. MELLEN
REGISTERED LAND SURVEYOR
TUCSON, ARIZONA
JOB # 95-35