

DISCLAIMER:

This unrecorded Record of Survey was donated to the City of Tucson. The City of Tucson provides this data for your personal use "as is." Additionally, the City of Tucson provides this information with the understanding that it is not guaranteed to be accurate, correct or complete and conclusions drawn from such information are the responsibility of the user.

NORTH

RESULTS OF SURVEY

OF A PORTION OF THE SOUTHEAST QUARTER OF THE NORTHEAST QUARTER OF SECTION 27, TOWNSHIP 13 SOUTH OF RANGE 15 EAST, GILA AND SALT RIVER BASE AND MERIDIAN, PIMA COUNTY, ARIZONA.

NOTES

- (1) - 0 INDICATES SET 1/2" PIN MKD L.S. 4680 UNLESS NOTED
- (2) M - MEASURED
- (3) R - MAP OR DEED RECORD
- (4) DOCKET 747 PAGE 487 DOES NOT EFFECT SUBJECT PROPERTY
- (5) SEE JOB #91-45 AND 93-118
- (6) ALL CORNERS FOUND OR SET AS OF 8-12-93



PARCELS 3A AND 3B	6/21/95
DETAIL-ESMTS	6/10/94
PARCELS I-II III	8/13/93
REVISIONS	DATE

RFM	ROBERT F. MELLEN	DATE: 4-10-91
	REGISTERED LAND SURVEYOR	DR BY: EMT CKBY: RFM
	1250 W. MOHAVE ST. TUCSON, ARIZONA	JOB NO. 94-94
	(602) 888-1012	SCALE: 1" = 60'
		SHEET 1 OF 1

DETAIL SCALE: 1" = 30'
SEWER & ACCESS EASEMENTS

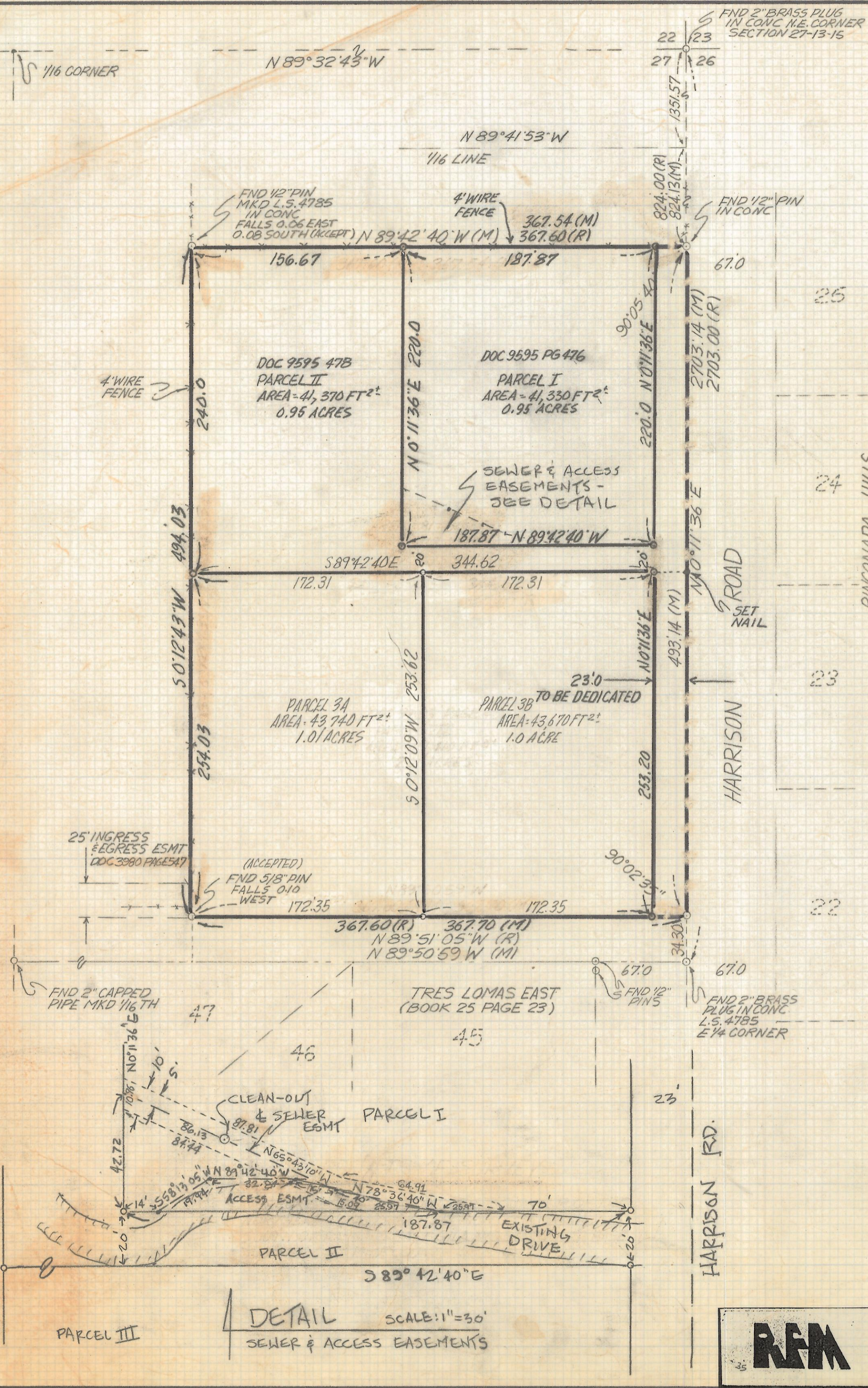

PARCEL III