

DISCLAIMER:

This unrecorded Record of Survey was donated to the City of Tucson. The City of Tucson provides this data for your personal use "as is." Additionally, the City of Tucson provides this information with the understanding that it is not guaranteed to be accurate, correct or complete and conclusions drawn from such information are the responsibility of the user.

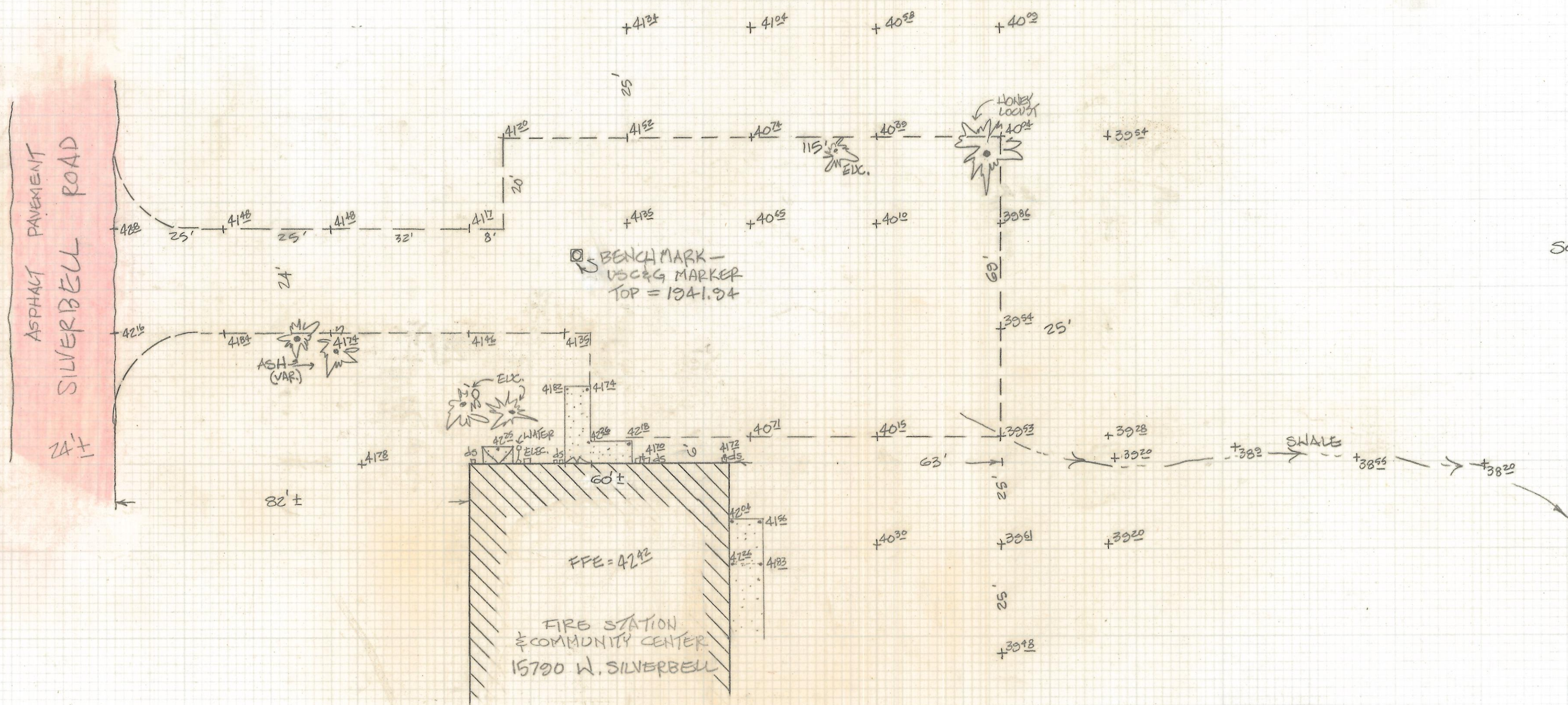

NOTE
 1) ds = DRAIN SPOUT - ELEV. AT CONG. SPLASH BLOCK

SKETCH

SHOWING EXISTING GRADES ADJACENT TO HALBERG COMMUNITY CENTER AND FIRE STATION LOCATED IN NORTHWEST QUARTER, SECTION 26, T-11-S, R-10-E, G & SFB & M, PIMA COUNTY, ARIZONA.



ROBERT F. MELLEN
 REGISTERED LAND SURVEYOR
 TUCSON, ARIZONA
 JOB 84-105