

DISCLAIMER:

This unrecorded Record of Survey was donated to the City of Tucson. The City of Tucson provides this data for your personal use "as is." Additionally, the City of Tucson provides this information with the understanding that it is not guaranteed to be accurate, correct or complete and conclusions drawn from such information are the responsibility of the user.

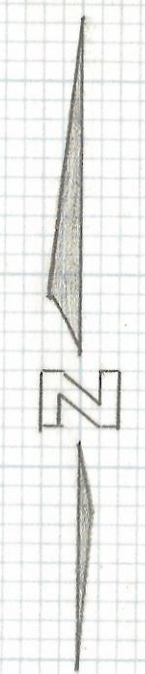
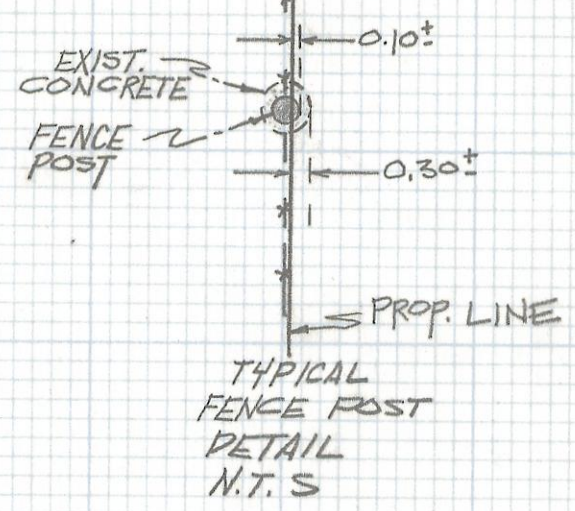
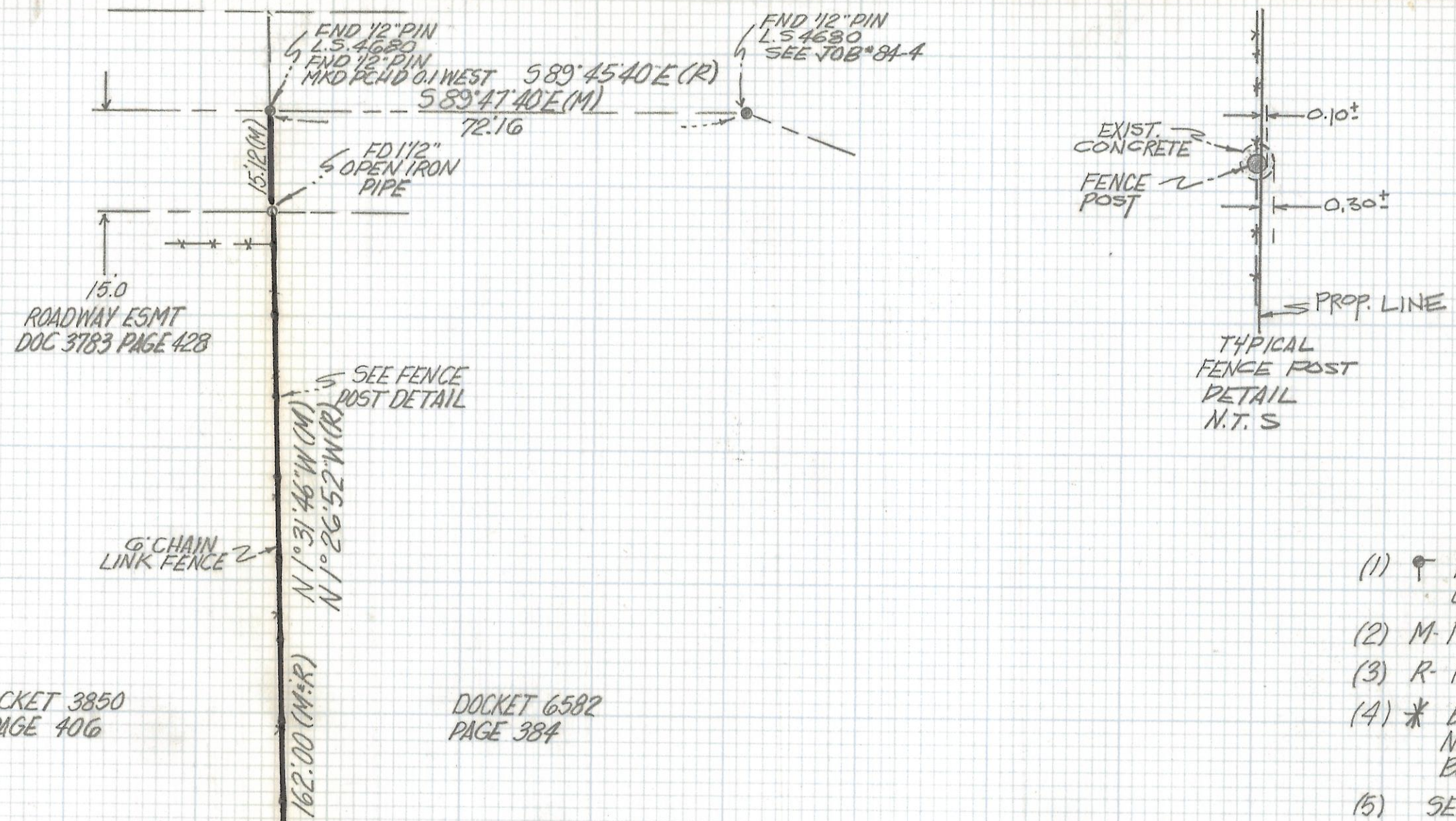

NOTES

- (1) INDICATES FOUND 1/2" PIN MKD L.S. 4680 UNLESS NOTED
- (2) M- MEASURED
- (3) R- MAP OR DEED RECORD
- (4) * BASIS OF BEARINGS N 89° 45' 40" W NORTH LINE BUENA VENTURA SUB. BOOK 13 PAGE 72 MAPS AND PLAT
- (5) SEE JOB* 84-4
- (6) THE SOUTHEAST CORNER SECTION 15 HAS BEEN DISPUTED FOR MANY YEARS THE CORNER USED IS REFERRED TO AS THE OLD SECTION CORNER AND NOT THAT ACCEPTED BY P.C.H.D

RESULTS OF SURVEY

OF A PORTION OF THE SOUTH HALF OF THE SOUTHEAST QUARTER SECTION 15 TOWNSHIP 13 SOUTH RANGE 13 EAST GILA AND SALT RIVER BASE AND MERIDIAN PIMA COUNTY ARIZONA

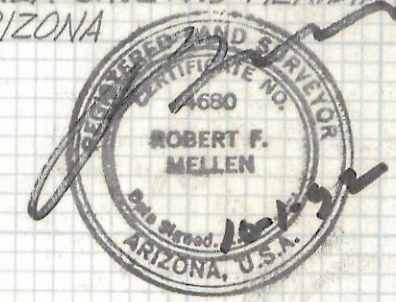

ROBERT F. MELLEN
REGISTERED LAND SURVEYOR
TUCSON, ARIZONA
JOB* 92-130

Z-2017-388

DOCKET 3850
PAGE 406

DOCKET 6582
PAGE 384

ROMERO PARK
BOOK 13 PAGE 45
DEC 1958

BUENA VENTURA
BOOK 13 PAGE 72
MARCH 1959

SEE NOTE #6

END PK NAIL
W/CROSSOUTS
SEE JOB* 84-4