

DISCLAIMER:

This unrecorded Record of Survey was donated to the City of Tucson. The City of Tucson provides this data for your personal use "as is." Additionally, the City of Tucson provides this information with the understanding that it is not guaranteed to be accurate, correct or complete and conclusions drawn from such information are the responsibility of the user.

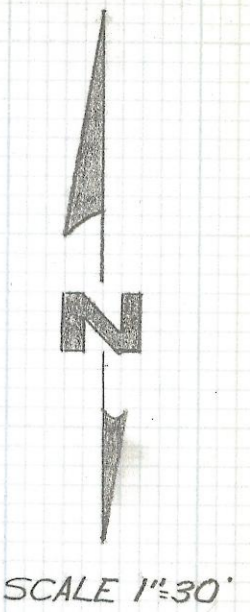
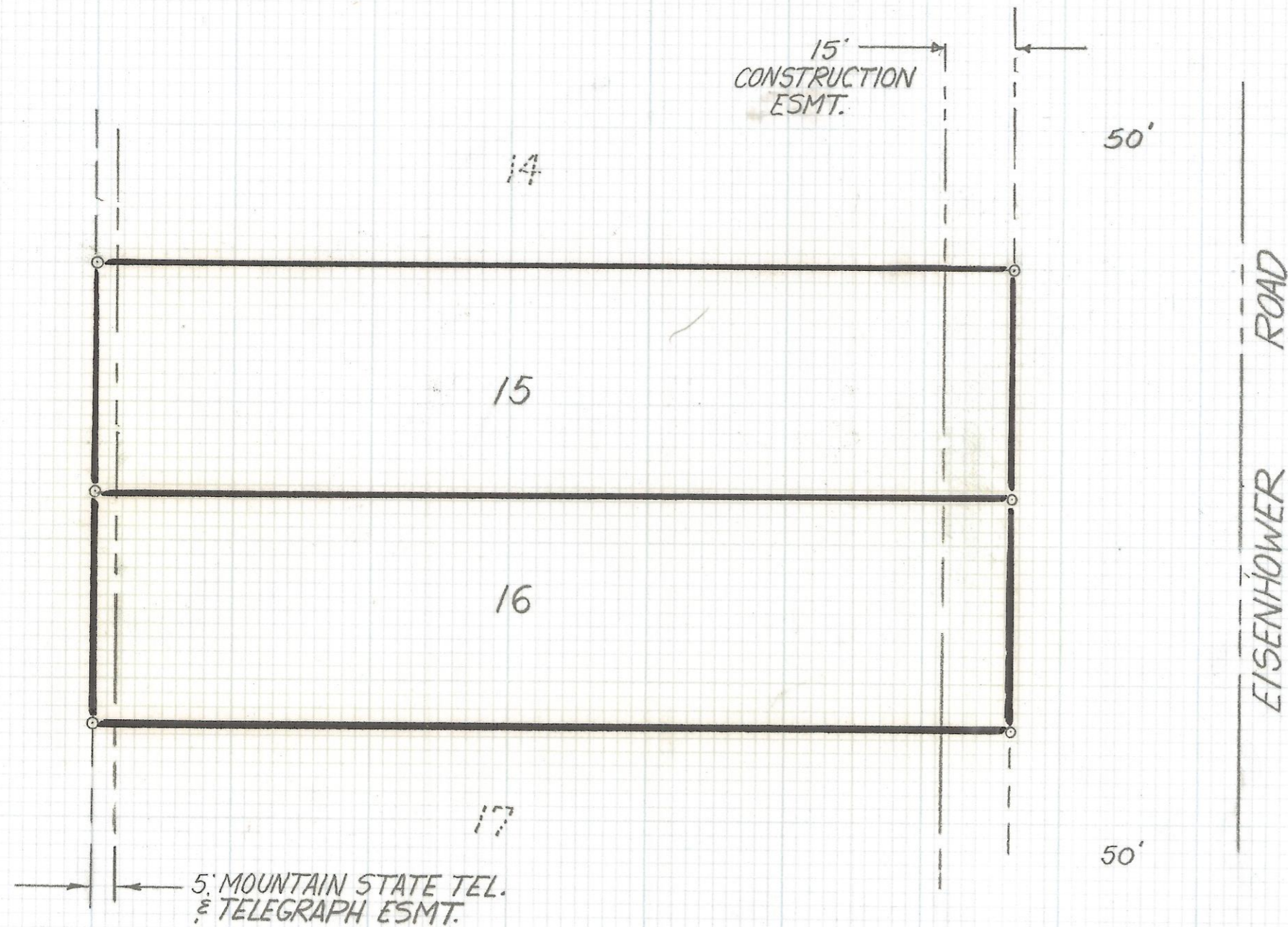

NOTES

- (1) —○ INDICATES SET 1/2" PIN L.S. 4680 UNLESS NOTED
- (2) M- MEASURED
- (3) R- MAP OR DEED RECORD

RESULTS OF SURVEY

OF LOTS 15 AND 16 SOUTHSIDE INDUSTRIAL SITES AS RECORDED IN BOOK 18 OF MAPS AND PLATS AT PAGE 39 IN THE OFFICE OF THE PIMA COUNTY RECORDER PIMA COUNTY, ARIZONA

Z-2017-489

REVISIONS		DATE
		DATE: 8-30-91
RFM	ROBERT F. MELLEN REGISTERED LAND SURVEYOR 1250 W. MOHAVE ST. TUCSON, ARIZONA (602) 888-1012	DR BY: EMT CK BY: RFM JOB NO. 91-106
	SCALE: 1"=30'	SHEET 1 OF 1