

SECTION 15,
T-15S, R-13E

SECTION 22,
T-15S, R-13E

LEGEND

- Existing city limits per Ordinances
Numbers 8151, 8283, 8531, 10487
- - - - - New city limits per Ordinance
Numbers _____

Area Annexed: 3.3 Acres ±



EXPIRES
06-30-2019

DRAWN BY: AGR - 6-21-18
 SCALE: NO SCALE
 APPROVED: _____
 for CITY ENGINEER

PROPOSED
 "SOUTH VALLEY INDIAN
 AGENCY CONNECT"
 ANNEXATION DISTRICT

CITY of TUCSON, ARIZONA
 ENGINEERING DIVISION

PLAN No. S-2018-003

ANNEXATION PETITION

TO: THE HONORABLE MAYOR & COUNCIL OF THE TOWN OF MARANA,
ARIZONA

We, the undersigned, being the owners of such real and personal property as would be subject to taxation by the City in the event of annexation of the area hereinafter described, as shown by the last assessment of said property by the County Assessor or by the State Tax Commission, in the case of property assessed by the State Tax Commission, request the Town of Marana, Arizona, to annex all of the real property owned by us and located in a territory contiguous to the Town of Marana, Arizona, but not now embraced within the limits of said Town, the external boundaries of the area to be annexed to the Town of Marana, Arizona being:

“SOUTH VALLEY INDIAN AGENCY CONNECT” Annexation District

A portion of Section 15, Township 15 South, Range 13 East, Gila and Salt River Meridian, State of Arizona, County of Pima, more particularly described as follows:

Commencing at the Southeast Corner of said Section 15;

Thence north along the east line of Section 15 to the southeast corner of the NE $\frac{1}{4}$ of Section 15;

Thence west along the south line of said NE ¼ to its intersection with the east line of Road #30 (known as Valley Indian Agency Connection Road) according to the map thereof of record in the Office of the County Recorder of Pima County, Arizona, in Book 1 of Road Maps at Page 71 thereof, being a point on the present corporate boundary of the City of Tucson;

Thence south along said east line of Road #30 (known as Valley Indian Agency Connection Road) , to its intersection with the easterly prolongation of the northerly line of that certain parcel as described in that *Warranty Deed* of record in said County Recorder's Office , Sequence NO. 20172860254, being a point on the present corporate boundary of the City of Tucson and the *POINT OF BEGINNING*;

Thence continue south along said east line of Road #30 (known as Valley Indian Agency Connection Road) , to its intersection with the easterly prolongation of the southerly line of that certain parcel as described in that *Mortgage* of record in said County Recorder's Office in Docket 4012 at Page 256 thereof, being a corner on the present corporate boundary of the City of Tucson;

Thence westerly along said easterly prolongation AND the southerly line of said parcel described in Docket 4012 at Page 256 thereof, to its intersection with the westerly line of said parcel described in Sequence NO. 20172860254 in said Recorder's Office, being a point on the present corporate boundary of the City of Tucson;

Thence north along said westerly parcel line of that parcel described in Sequence NO. 20172860254, to its intersection with the northerly line of said parcel described in Sequence NO. 20172860254 in said Recorder's Office;

Thence easterly along said northerly line described in Sequence NO. 20172860254 in said Recorder's Office and its easterly prolongation to the *POINT OF BEGINNING*.

Said District containing 3.3 acres, more or less.

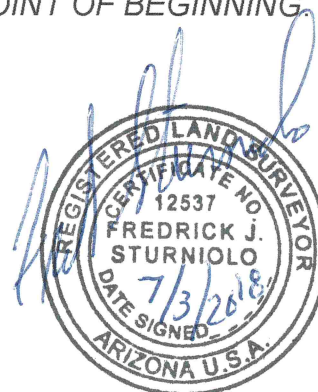



July 3, 2018

City of Tucson
Office of the City Manager
Attn: Mike Czechowski

Subject: "South Valley Indian Agency Connect" Annexation District

Dear Mr. Czechowski:

This submittal contains the following:

- a) The original signed and sealed legal description for the petition.
- b) The original drawing S-2018-003 for use as the petition map.
- c) A signed and sealed copy of Drawing No. B-2018-002 of the subject annexation plat.
- d) The invoice for survey services for this annexation.

Copies in ".pdf format" will be forwarded to you by email when requested.
If you have any questions or concerns, please contact me at (520) 298-3200.

Sincerely,

A handwritten signature in black ink, which appears to read "Fred Sturniolo", is written over a horizontal line.

Fred Sturniolo R.L.S.

Cc: TDOT/Eng Div.-Maps and Records