

# **DISCLAIMER:**

**This unrecorded Record of Survey was donated to the City of Tucson. The City of Tucson provides this data for your personal use "as is." Additionally, the City of Tucson provides this information with the understanding that it is not guaranteed to be accurate, correct or complete and conclusions drawn from such information are the responsibility of the user.**

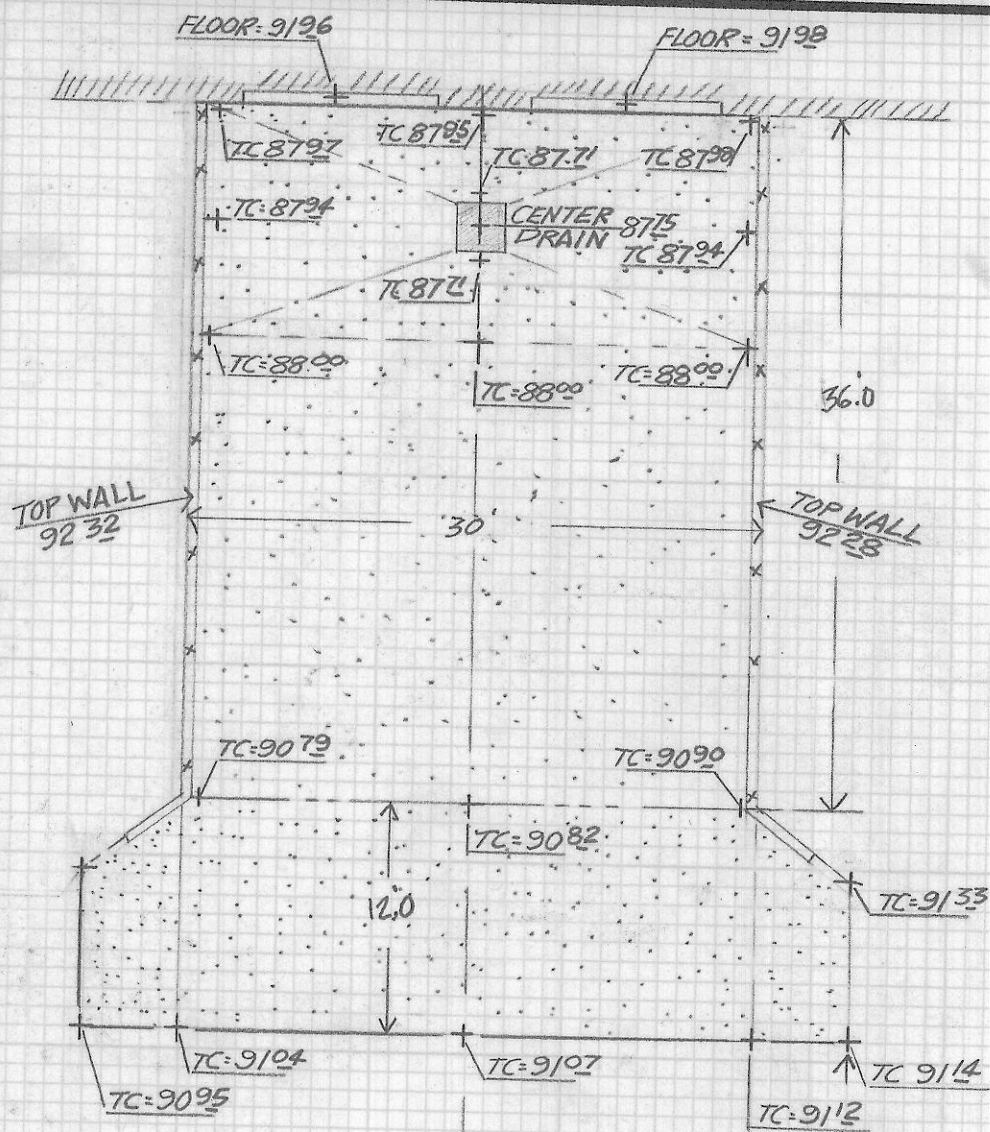

NORTH  
SCALE 1"=10'



NOTE

BENCHMARK ELEVATION 2485.98" X ON MID-RADIUS OF CONCRETE CURB AT N.E. CORNER OF PALMDALE AND PARK CITY OF TUCSON F.B. 1536 P649

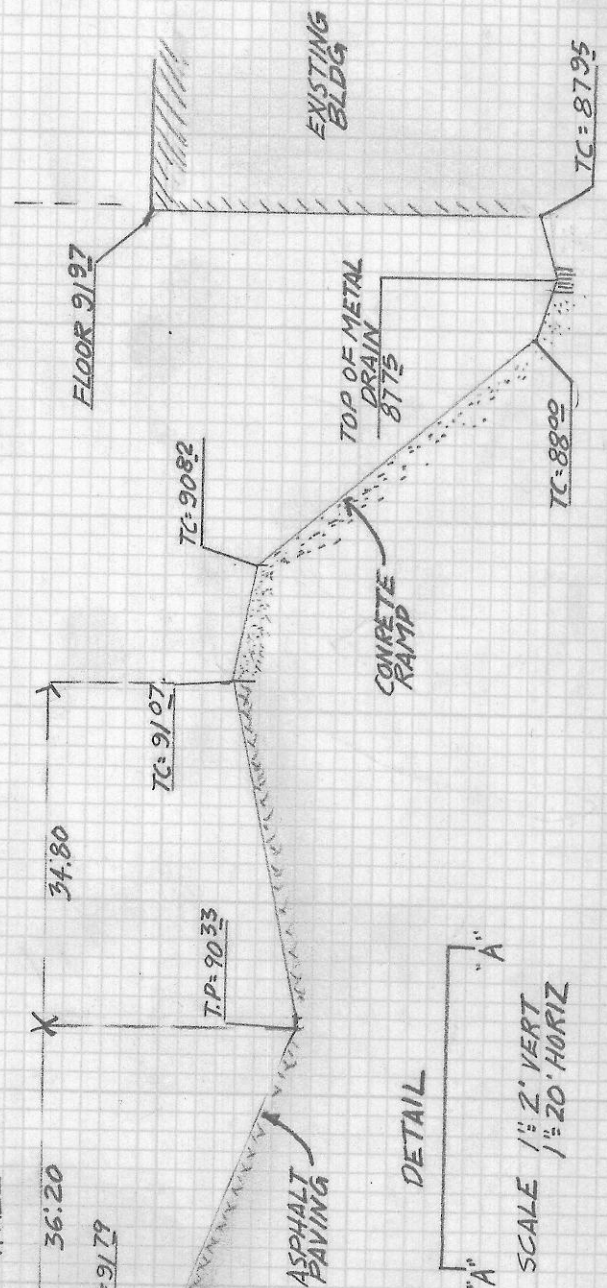
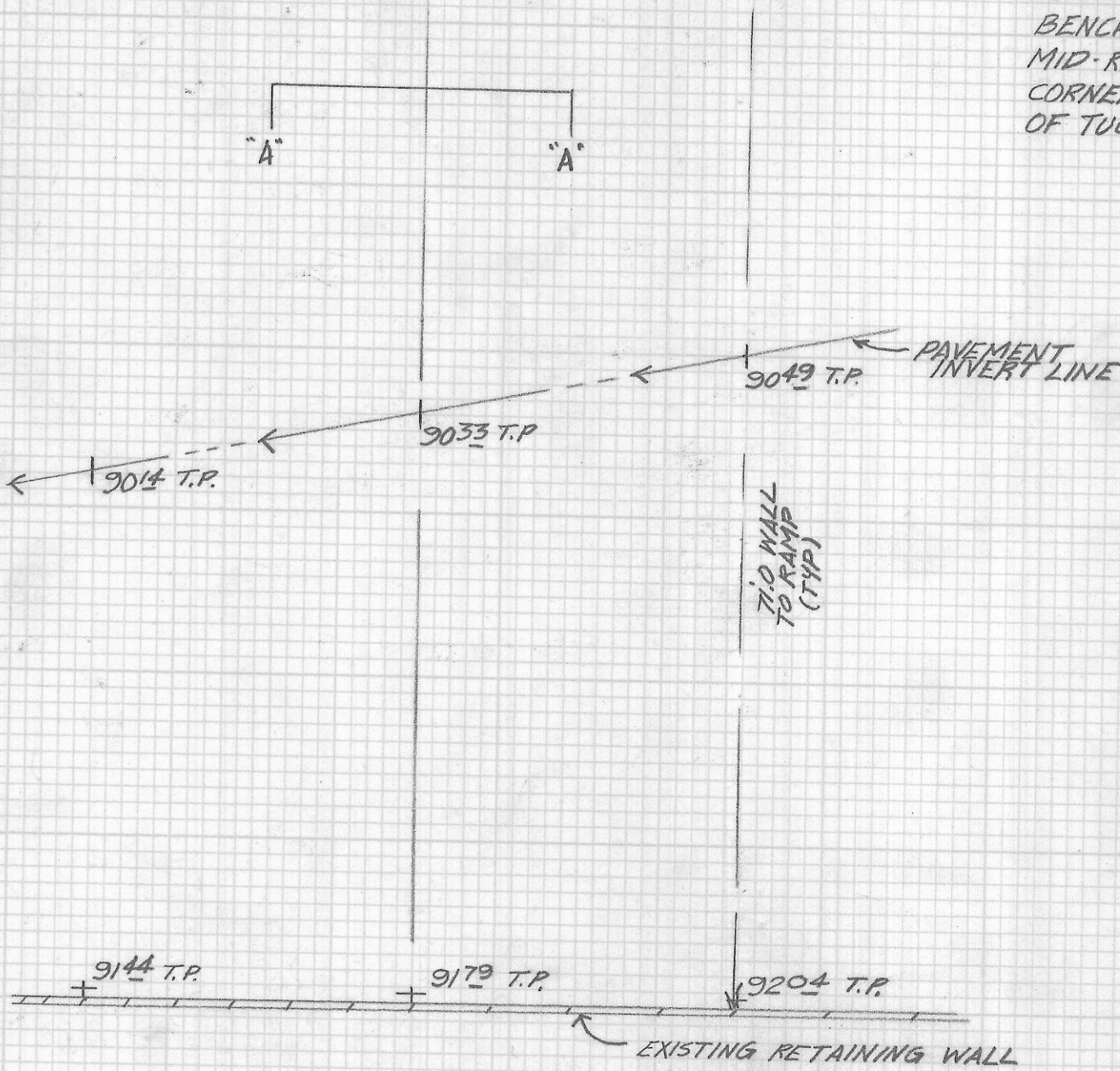

SKETCH  
OF

EXISTING GRADES OF RAMP FOR THE HINSDALE INDUSTRIES WHICH IS IN LOT 11 OF TUCSON BUSINESS PARK RECORDED IN BOOK 26 OF MAPS AND PLATS AT PAGE 79 IN THE OFFICE OF THE PIMA COUNTY RECORDER PIMA COUNTY, ARIZONA

ROBERT F. MELLEN  
REGISTERED LAND SURVEYOR  
TUCSON, ARIZONA  
JOB # 89-40

Z-2018-095