

# **DISCLAIMER:**

**This unrecorded Record of Survey was donated to the City of Tucson. The City of Tucson provides this data for your personal use "as is." Additionally, the City of Tucson provides this information with the understanding that it is not guaranteed to be accurate, correct or complete and conclusions drawn from such information are the responsibility of the user.**

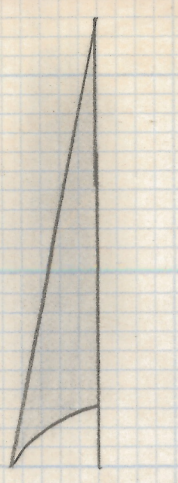

NORTH

SCALE: 1" = 50'

DOCKET 6586 PG 228

DOCKET 7382 PG 50R

DOCKET 7382 PG 50Z

DOCKET 3961 PAGE 545

FND ACP MKD L.S. 105Z

S 41° 03' 19" W 156.25

N 48° 56' 41" W 189.83 (M)

276.23 (M) S 14° 40' 26" W

FND ACP MKD L.S. 105Z

S 46° 47' 47" E 148.5

SET PIN 11.5 N.W. ON LINE

478.95

FND ACP L.S. 105Z

NOTES:

- (1) ♀ INDICATES SET 1/2" PIN MKD L.S. 4680 UNLESS NOTED
- (2) R- MAP OR DEED RECORD
- (3) M- MEASURED
- (4) SEE JOB# 85-138
- (5) PORTIONS OF OX-BOX ROAD LIE WITHIN LOT 26 AND ARE SHOWN ON THE SUBDIVISION PLAT OF TUCSON FOOTHILLS ESTATES#2

112.94 N 86° 35' 00" W

49.77

FND 3/8" PIN

S 15° 28' 09" W 359.06

SEE NOTE #5

AREA = 144,160 FT<sup>2</sup> 3.31 ACRES ±

POWER POLE

DOWN CUT

OX-BOX RD DIRT PT FOR CURVE

### RESULTS OF SURVEY

OF A PORTION OF THE SOUTHEAST QUARTER OF THE SOUTHWEST QUARTER OF SECTION NINETEEN TOWNSHIP THIRTEEN SOUTH OF RANGE THIRTEEN EAST, GILA AND SALT RIVER BASE AND MERIDIAN, PIMA COUNTY ARIZONA

LOT 26

392.66 N 2° 25' 39" E

N 21° 12' 09" E 201.65

N 18° 47' 52" W 363.41

N 18° 47' 52" W 225.61

304.17

EAST 2547.2

FND 1" O.I.P.

1/2" PIN

FND 1" O.I.P.

SWEETWATER DRIVE

FND CONC MARKER SET 1/16 FROM P.L.T.I.E.S.

SEC 24 FND 2" O.I.P.  
SEC 19  
SEC 25  
DEC 30

SE COR LOT 26 SET PIN FND 3/8" PIN 1.93 WEST

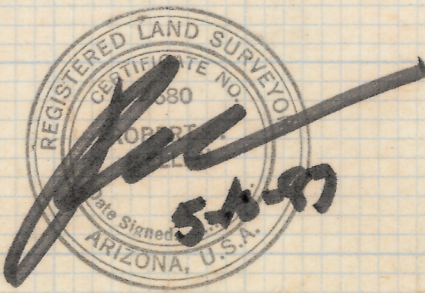

Z-2018-242  
ROBERT F. MELLEN  
REGISTERED LAND SURVEYOR  
TUCSON, ARIZONA  
JOB# 86-115