

DISCLAIMER:

This unrecorded Record of Survey was donated to the City of Tucson. The City of Tucson provides this data for your personal use "as is." Additionally, the City of Tucson provides this information with the understanding that it is not guaranteed to be accurate, correct or complete and conclusions drawn from such information are the responsibility of the user.

GUNPOINT DRIVE

30.0

FD 5/8" PIN

H 88° 43' 55" W 297.45 M
 H 88° 31' 12" W 297.68 R

FD 5/8" PIN

13.64

FD 5/8" PIN

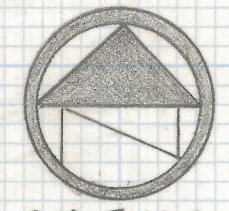

SCALE 1" = 30.0'

N 0° 38' 55" E MTR
 159.87 M 160.0 R

160.02 MTR
 N 0° 02' 47" E M
 N 0° 20' 05" E R

LOT 3

50-YEAR FLOOD LIMITS

NOTES

- (1) - Q INDICATES SET 1/2" PIN MKD L.S. 4680 UNLESS NOTED
- (2) M - MEASURED
- (3) R - MAP OR DEED RECORD
- (4) ALL 5/8" PINS FOUND TAGGED P.E. 2663 OR P.E. 5178

SET NAIL

HORSE CORRAL ENCROACHES ONTO LOT 3

H 88° 42' 28" W (M) 299.14 M
 H 88° 31' 12" W (R) 298.55 R 3.7

LOT 2

30.0

159.87 M 160.0 R

FD 5/8" PIN

160.01 MTR

FD 5/8" PIN

RESULTS RESULTS OF SURVEY

LOT 3 AMMON ACRES RECORDED IN BOOK 24 OF MAPS AND PLATS AT PAGE 48 IN THE OFFICE OF THE PIMA COUNTY, RECORDER PIMA COUNTY ARIZONA

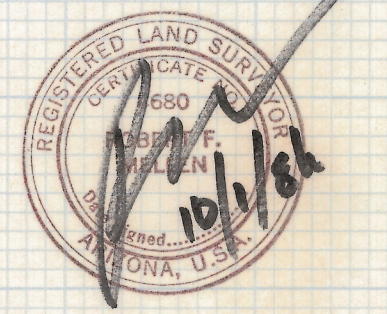

Z-2018-253
 ROBERT F. MELLEN
 REGISTERED LAND SURVEYOR
 TUCSON, ARIZONA
 JOB # 86-131