

DISCLAIMER:

This unrecorded Record of Survey was donated to the City of Tucson. The City of Tucson provides this data for your personal use "as is." Additionally, the City of Tucson provides this information with the understanding that it is not guaranteed to be accurate, correct or complete and conclusions drawn from such information are the responsibility of the user.

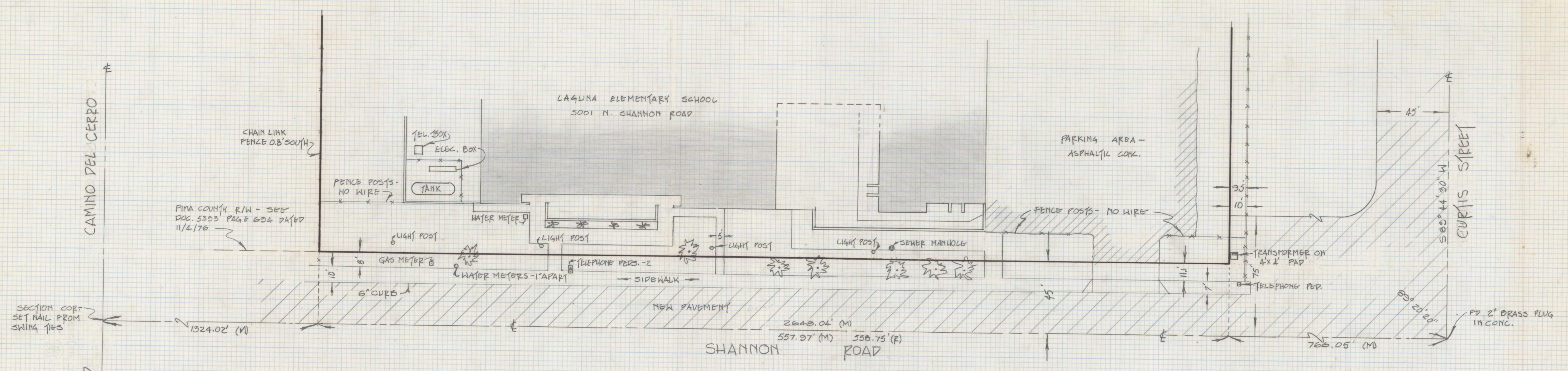
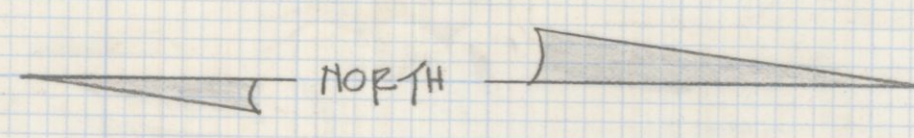

NOTES:

- (1) R - MAP OR DEED RECORD
- (2) M - MEASURED
- (3) THE FOLLOWING EASEMENTS AFFECT THIS PROPERTY:
 - (A) D.R.E. BOOK 52 PG 348 (1912)
ARIZONA TELEPHONE AND TELEGRAPH TO MOUNTAIN STATE BLANKET
SE 1/4 - 17-13-13
 - (B) D.R.E. BOOK 64 PG 472-485 TUCSON FARMS TO TUCSON ELCC ALL
OF NE 1/4 OF SE 1/4 EAST OF RAILROAD
 - (C) D.R.E. BOOK 124 PG 228 4/23/20 TO TUCSON GAS & ELCC. BLANKET
EASEMENT.

RESULTS OF SURVEY

OF EAST LINE OF LAGUNA ELEMENTARY SCHOOL, A PORTION OF
NORTHEAST 1/4 OF SOUTHEAST 1/4 OF SECTION 17, TOWNSHIP 13
SOUTH, RANGE 13 EAST, GILA AND SALT RIVER BASE AND MERIDIAN
PIMA COUNTY, ARIZONA.



Z-2018-320
ROBERT F. MULLEN
REGISTERED LAND SURVEYOR
TUCSON, ARIZONA
JOB - 85-72