

DISCLAIMER:

This unrecorded Record of Survey was donated to the City of Tucson. The City of Tucson provides this data for your personal use "as is." Additionally, the City of Tucson provides this information with the understanding that it is not guaranteed to be accurate, correct or complete and conclusions drawn from such information are the responsibility of the user.

PIMA AVENUE



SCALE 1" = 30'

BRYANT STREET

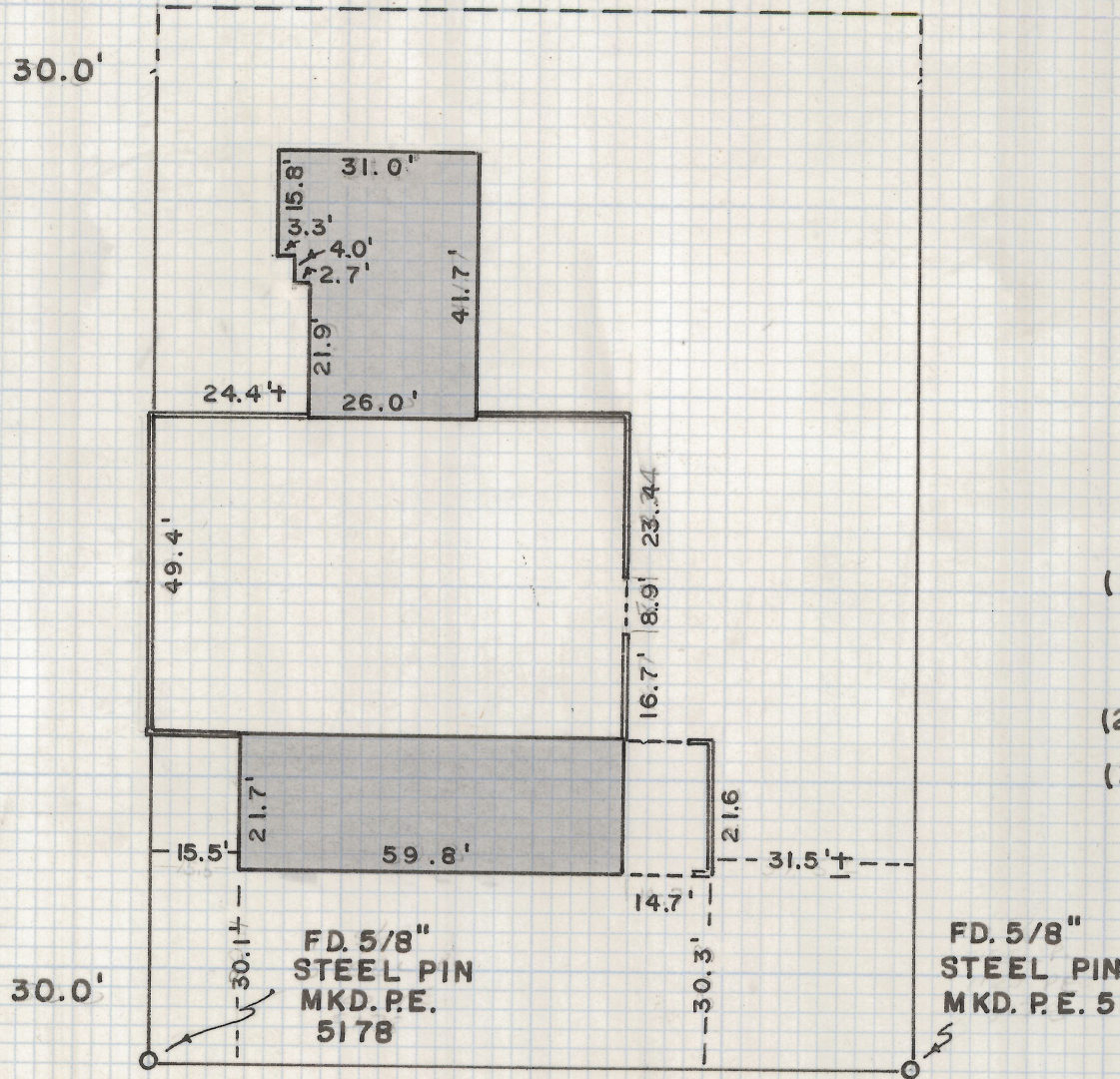

NOTES

- (1)  INDICATES 1/2" STEEL PIN SET MKD. L.S. 4680 UNLESS NOTED
- (2) M - MEASURED
- (3) R - MAP OR DEED RECORD

RESULTS OF SURVEY

OF A PORTION OF LOT SIX, BLOCK SIXTEEN OF SPEEDWAY ADDITION NO. 1 AS RECORDED IN BOOK THREE OF MAPS AND PLATS AT PAGE NINETY-FIVE IN THE OFFICE OF THE PIMA COUNTY RECORDER, PIMA COUNTY, ARIZONA

ROBERT F. MELLEN
 REGISTERED LAND SURVEYOR
 TUCSON, ARIZONA
 JOB #78-115
 OCT. 1978

Z-2019-001