

# **DISCLAIMER:**

**This unrecorded Record of Survey was donated to the City of Tucson. The City of Tucson provides this data for your personal use "as is." Additionally, the City of Tucson provides this information with the understanding that it is not guaranteed to be accurate, correct or complete and conclusions drawn from such information are the responsibility of the user.**





SCALE 1" = 60'

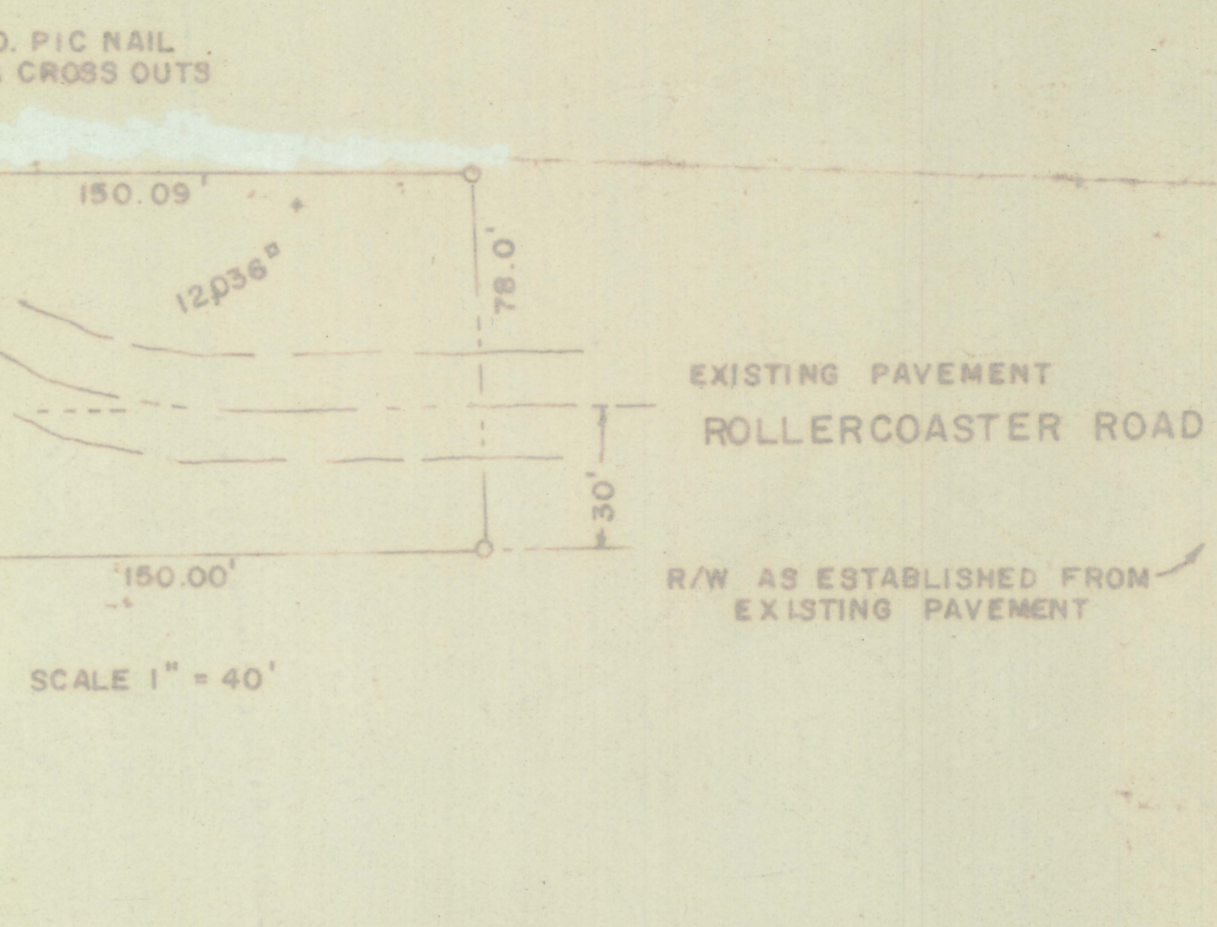

SCALE 1" = 40'

### RESULTS OF SURVEY OF

THE WEST 150 FEET OF THE NORTHWEST QUARTER OF THE SOUTHEAST QUARTER OF SECTION 15, TOWNSHIP 13 SOUTH OF RANGE 13 EAST, GILA AND SALT RIVER BASE AND MERIDIAN, PIMA COUNTY, ARIZONA

TOTAL AREA OF SURVEY	19,256	4.46 ACRES	5.396 COMM. AC.
TAKEN BY ROAD	12,036	0.276 ACRES	0.334 COMM. AC.
IN WASH	32,745	0.752 ACRES	0.909 COMM. AC.
TOTAL USABLE LAND	149,475	3.43 ACRES	4.15 COMM. AC.

ROBERT F. NELLEN  
REGISTERED LAND SURVEYOR  
TUCSON, ARIZONA

JOB # 72-52

Z-2020-175

72-37