

DISCLAIMER:

This unrecorded Record of Survey was donated to the City of Tucson. The City of Tucson provides this data for your personal use "as is." Additionally, the City of Tucson provides this information with the understanding that it is not guaranteed to be accurate, correct or complete and conclusions drawn from such information are the responsibility of the user.

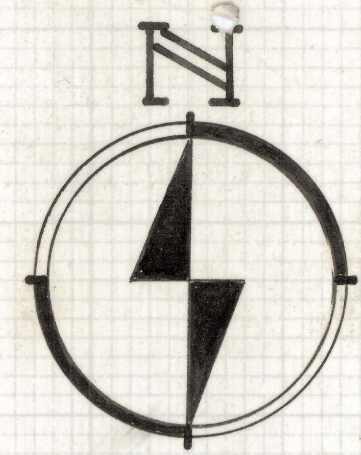

SCALE 1" = 40'

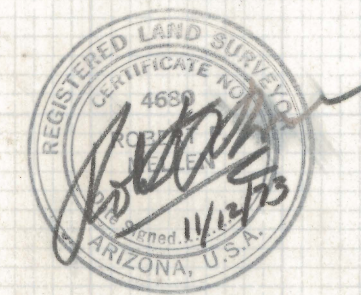

RESULTS OF TOPOGRAPHICAL SURVEY

OF A PORTION OF U.S. GOVT. LOT NUMBER THIRTY-SIX BEING THE WEST HALF OF THE SOUTHWEST QUARTER OF THE SOUTHEAST QUARTER OF THE SOUTHEAST QUARTER OF SECTION SIX, TOWNSHIP FIFTEEN SOUTH OF RANGE THIRTEEN EAST, GILA AND SALT RIVER BASE AND MERIDIAN, PIMA COUNTY, ARIZONA

NOTES

- (1) THIS IS A TOPOGRAPHICAL SURVEY ONLY THE BOUNDARY DIMENSIONS ARE TAKEN FROM EXISTING PUBLIC RECORDS AND NO CORNERS WERE SET
- (2) R - MAP RECORD
- (3) M - MEASURED

ROBERT F. MELLE N
REGISTERED LAND SURVEYOR
TUCSON, ARIZONA

JOB # 73-143

Z-2020-208