

DISCLAIMER:

This unrecorded Record of Survey was donated to the City of Tucson. The City of Tucson provides this data for your personal use "as is." Additionally, the City of Tucson provides this information with the understanding that it is not guaranteed to be accurate, correct or complete and conclusions drawn from such information are the responsibility of the user.

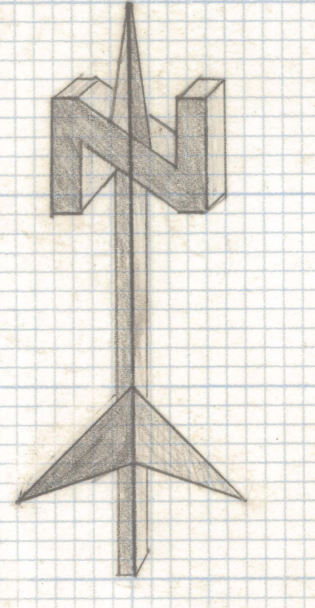

SCALE 1"=20'

RESULTS OF SURVEY

OF A PORTION OF THE NORTH 290 FEET OF THE EAST 751.4 FEET OF THE WEST 781.4 FEET OF THE SOUTH HALF OF THE NORTHWEST QUARTER OF THE SOUTHEAST QUARTER SECTION 22 TOWNSHIP 13 SOUTH RANGE 13 EAST GILA AND GALT RIVER BASIN AND MERIDIAN PIMA COUNTY ARIZONA

NOTES

- (1) SPRINKLER SYSTEM INSTALLED IN GRASS AREA
- (2) BENCH MARK FLOW LINE OF MANHOLE #1 FLOWLINE ELEVATION 2289.89 PLAN SUB# 114 SANITARY DIST #1 (NOW PIMA COUNTY WASTE WATER MANAGEMENT)
- (3) THE HOUSE CONNECTIONS TO DAVIS SCHOOL WERE TAKEN FROM EXISTING PLANS AND WERE NOT VERIFIED
- (4) THERE IS A 30" SANITARY SEWER LINE IN THE APPROXIMATE CENTER LINE OF ROMERO ROAD AND A MANHOLE WHERE THIS LINE INTERSECTS THE CENTER LINE OF ROOT LANE THE APPROXIMATE ELEVATION OF THE FLOWLINE IS 2286.1'
- (5) THERE IS ALSO A SEWER HOUSE CONNECTION TO THE MOBILE USED AS A SECURITY TRAILER NEAR THE NORTHEAST CORNER OF PARK EL MONTE SUBDIVISION

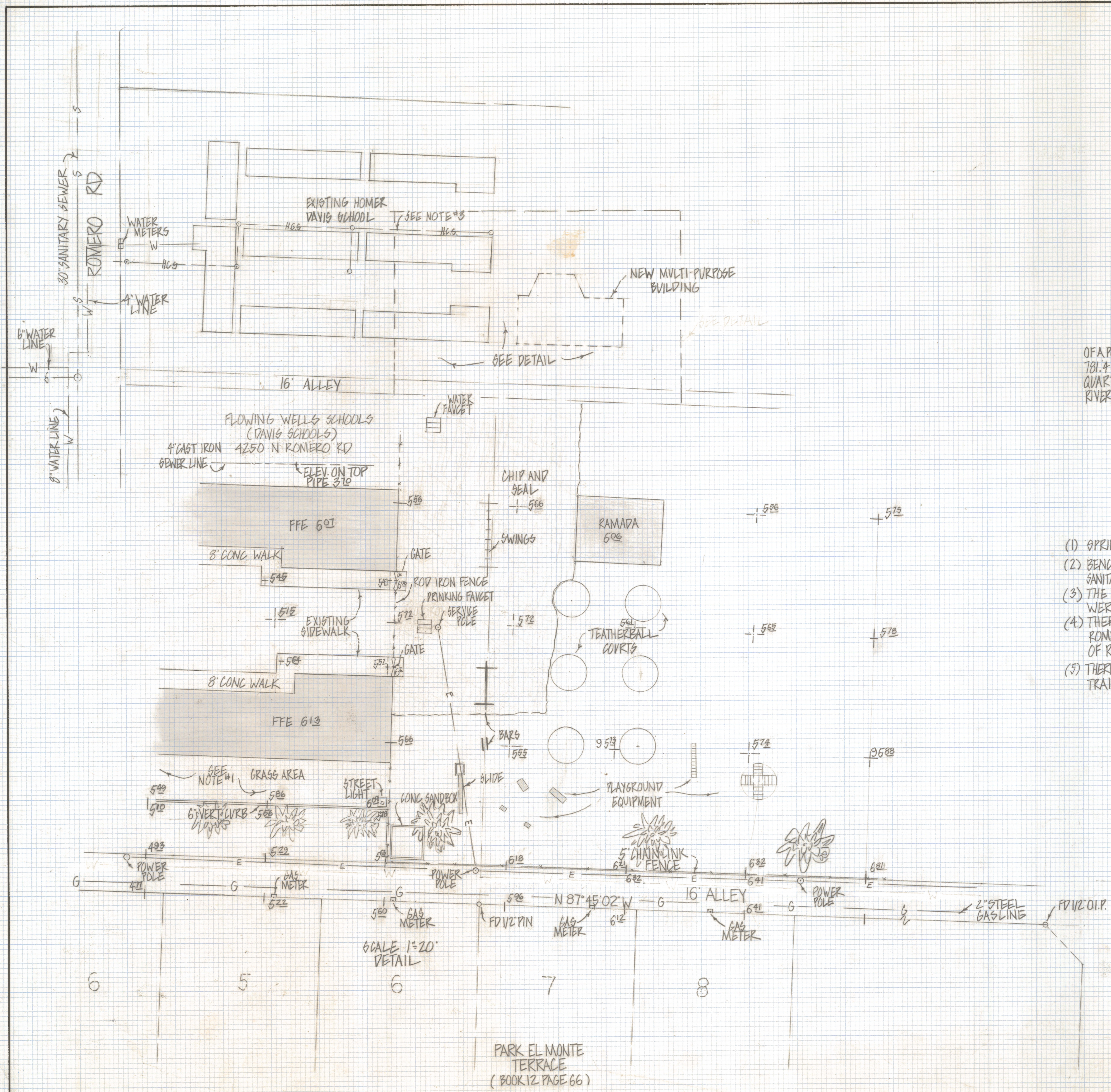

PARK EL MONTE TERRACE (BOOK 12 PAGE 66)



ROBERT F. MELLEN
REGISTERED LAND SURVEYOR
TUCSON ARIZONA
JOB #82-61

REVISED 7/27/82