

DISCLAIMER:

This unrecorded Record of Survey was donated to the City of Tucson. The City of Tucson provides this data for your personal use "as is." Additionally, the City of Tucson provides this information with the understanding that it is not guaranteed to be accurate, correct or complete and conclusions drawn from such information are the responsibility of the user.

TAYLOR LANE

FD 2" BRASS
PLUG IN CONC

ORANGE GROVE ROAD

N 89° 48' 52" E

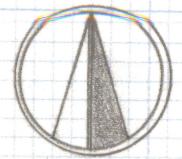

SCALE 1"=60'

663.32

221.10

30

20' ELECTRICAL
EASEMENT

NEW OVERHEAD
ELECTRIC

RESULTS OF SURVEY

OF A PORTION OF THE NORTHWEST QUARTER
OF THE NORTHEAST QUARTER OF SECTION 9
TOWNSHIP 13 SOUTH RANGE 11 EAST GILA AND
SALT RIVER BASE AND MERIDIAN PIMA COUNTY
ARIZONA

219.84

PARCEL
PK-1A

219.84

SET 1/2" PIN
L.S. 4680

N 89° 48' 51" E

SET 1/2" PIN
L.S. 4680

PARCEL
PK-2

221.03

NOTES

(1) • INDICATES FOUND 1/2" PIN MKD L.S. 4680
FROM JOB# 81-40 UNLESS NOTED

439.69

60° 15' 55" E

219.85

PARCEL
PK-1B

219.85

50° 14' 42" E



220.95

N 89° 48' 51" E

30' ACCESS
AND UTILITY EASEMENT

ROBERT F. MELLEN
REGISTERED LAND SURVEYOR
TUCSON, ARIZONA
JOB# 83-26

Z-2020-433-001

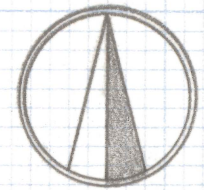

SCALE 1"=60'

ORANGE GROVE ROAD
N 89° 48' 52" E

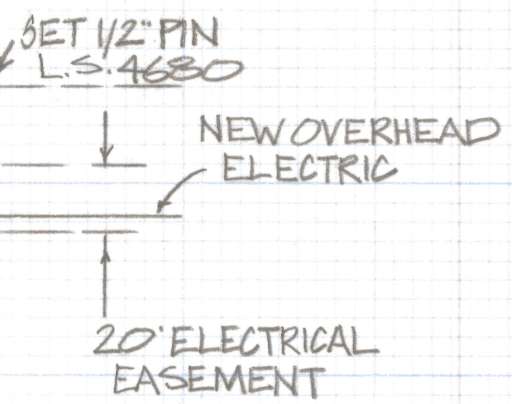
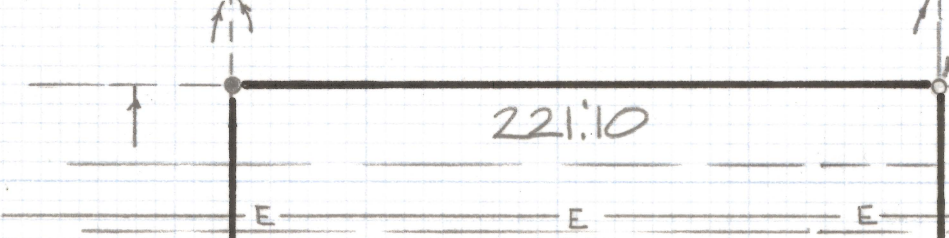

PARCEL
PK-1A

219.84

SET 1/2" PIN
L.S. 4680

439.69

PARCEL
PK-2

SET 1/2" PIN
L.S. 4680

439.69

PARCEL
PK-3

50' 13.28' E

PARCEL
PK-2A

219.85 60' 14.42" E

220.95
N 89° 48' 51" E

RESULTS OF SURVEY

OF A PORTION OF THE NORTHWEST QUARTER
OF THE NORTHEAST QUARTER OF SECTION 9
TOWNSHIP 13 SOUTH RANGE 11 EAST GILA
AND SALT RIVER BASE AND MERIDIAN PIMA
COUNTY ARIZONA

NOTES

- (1) ● INDICATES FOUND 1/2" PIN MKD L.S. 4680 FROM JOB #81-40 UNLESS NOTED
- (2) THE TITLE REPORT FURNISHED DOES NOT MENTION ANY LAND TAKEN FOR ORANGE GROVE ROAD HOWEVER AT LEAST 30' FEET OF THIS PARCEL IS OCCUPIED AS A ROADWAY

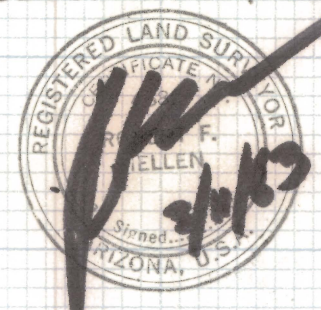

ROBERT F. MELLEN
REGISTERED LAND SURVEYOR
TUCSON, ARIZONA
JOB # 83-26