

DISCLAIMER:

This unrecorded Record of Survey was donated to the City of Tucson. The City of Tucson provides this data for your personal use "as is." Additionally, the City of Tucson provides this information with the understanding that it is not guaranteed to be accurate, correct or complete and conclusions drawn from such information are the responsibility of the user.

3

TANQUE VERDE WASH

LOT 44
LA CEBADILLA ESTATES
BOOK 25 PAGE 78 M&P

FD. 3/4" OIP
MKD. L.S. 4253

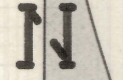

SCALE 1" = 100'

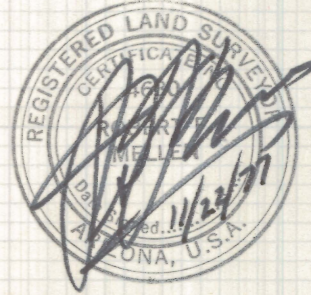

N 29° 01' 56" E

FD. 3/4" OIP
MKD. L.S. 4253

N 28° 25' 19" E
33.41'

S 89° 58' 31" E 301.47'

FD. 5/8" STEEL PIN
MKD. RE. 2663

M 36.50'

FD. 3/4" OIP
NOT MKD.

N 00° 04' 21" W 1155.96'

8.0 AC. ±
348,391 FT.²

S 0° 04' 21" E 1155.96'

N 00° 04' 21" W

RESULTS OF SURVEY

OF A PORTION OF THE SOUTHWEST QUARTER
OF SECTION THREE, TOWNSHIP FOURTEEN SOUTH
OF RANGE SIXTEEN EAST, GILA AND SALT RIVER
BASE AND MERIDIAN, PIMA COUNTY, ARIZONA

NOTES

- (1) SURVEY REFERENCES
 - (1) CELLA, BARR & EVANS JOB # 73006-002
 - (2) HECTOR DURAND JOB # A-933-71
- (2) ♂ INDICATES 1/2" STEEL PIN SET MKD. L.S. 4680 UNLESS NOTED
- (3) M- MEASURED DISTANCE
- (4) OIP- OPEN IRON PIPE
- (5) BASIS OF BEARINGS- CBE PLAT # 73006-002

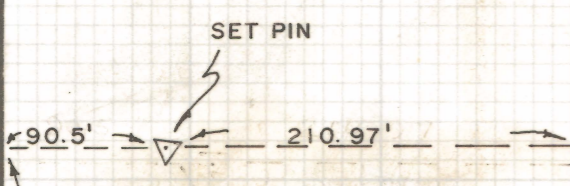

FD. 3/4" OIP
MKD. L.S. 4253

301.47'

N 89° 58' 31" W

358.53'

FD. 3/4" OIP
MKD. L.S. 4253

S 1/4 COR. SEC. 3
FD. BRASS PLUG
IN CONC.

EAST SPEEDWAY

ROBERT F. MELLEN
REGISTERED LAND SURVEYOR
TUCSON, ARIZONA
JOB # 77-152
NOV. 1977

REVISED - 12/8/77

Z-2020-911