

DISCLAIMER:

This unrecorded Record of Survey was donated to the City of Tucson. The City of Tucson provides this data for your personal use "as is." Additionally, the City of Tucson provides this information with the understanding that it is not guaranteed to be accurate, correct or complete and conclusions drawn from such information are the responsibility of the user.

STREET KELSO

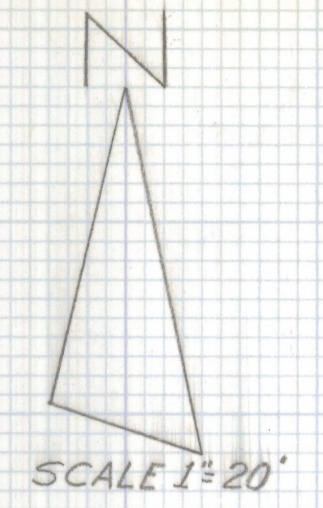
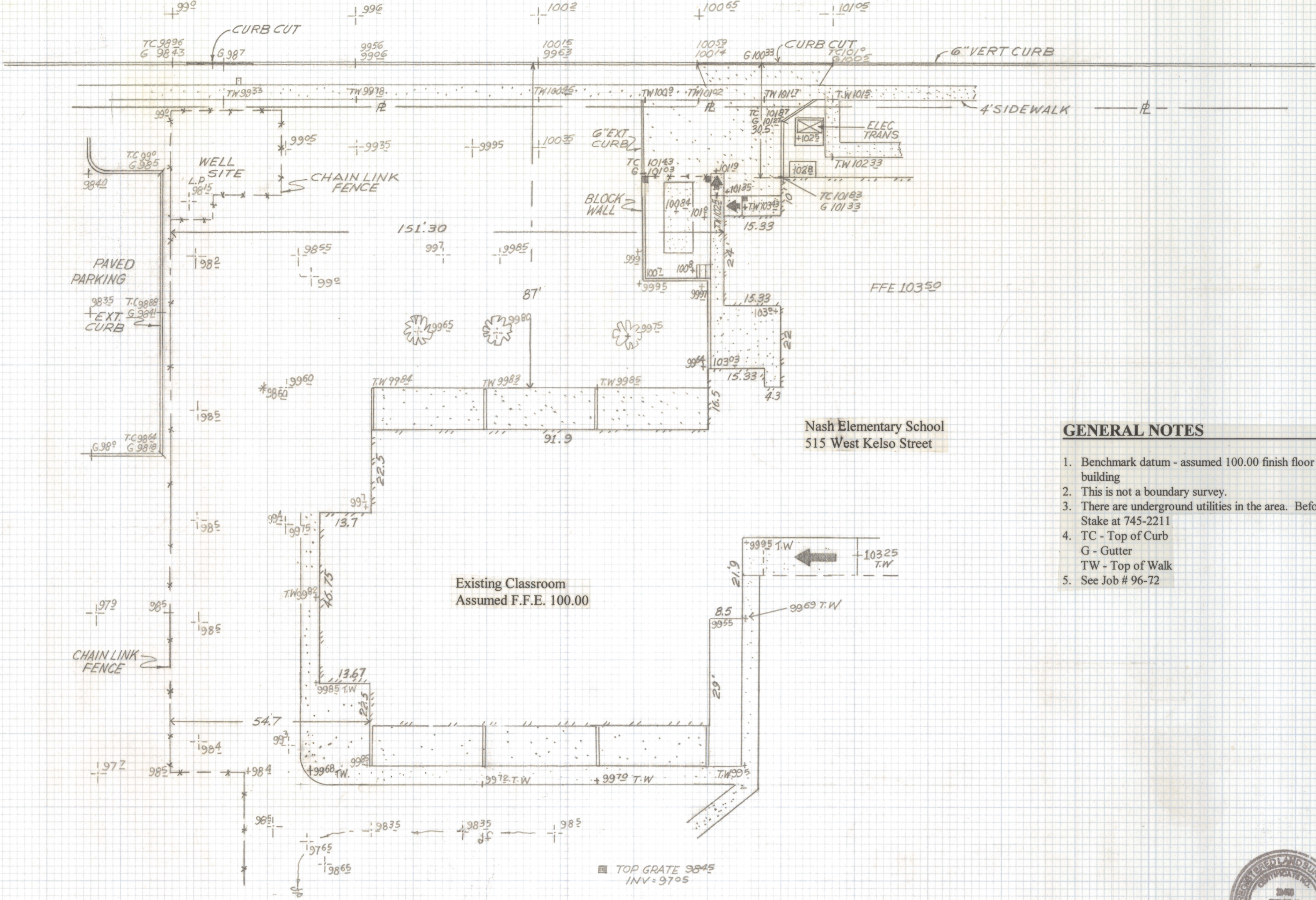

GENERAL NOTES

1. Benchmark datum - assumed 100.00 finish floor for North classroom building
2. This is not a boundary survey.
3. There are underground utilities in the area. Before digging call Blue Stake at 745-2211
4. TC - Top of Curb
G - Gutter
TW - Top of Walk
5. See Job # 96-72

SITE SURVEY

Of a portion of Nash Elementary School located at 515 West Kelso Street, Tucson, Arizona.



DATE	REVISIONS
EVERETT M. TRUEBLOOD LAND SURVEYING 2300 West Ian Place Tucson, AZ 85741 (520) 888-2549	
Drawn By: EMT	Checked By: EMT
Job No. 97-125	Date: October 24, 1997
Scale: 1" = 20'	Sheet 1 of 1