

DISCLAIMER:

This unrecorded Record of Survey was donated to the City of Tucson. The City of Tucson provides this data for your personal use "as is." Additionally, the City of Tucson provides this information with the understanding that it is not guaranteed to be accurate, correct or complete and conclusions drawn from such information are the responsibility of the user.

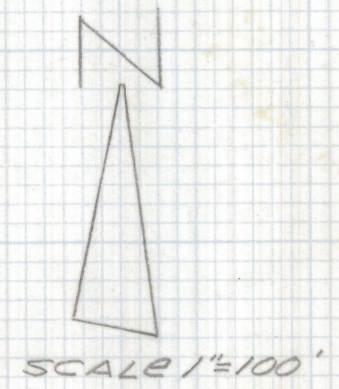

- Notes
- 1) ♀ INDICATES FOUND 1/2" PIN UNLESS NOTED
 - 2) M. MEASURED
 - 3) R. MAP OF DEED RECORD
 - 4) BASIS OF BEARINGS West ASSUMED SOUTH LINE OF PARCELS 4 AND 14 AS SHOWN ON ASSESSOR'S MAP OF SECTION 35-14-11 IN THE NORTHEAST QUARTER

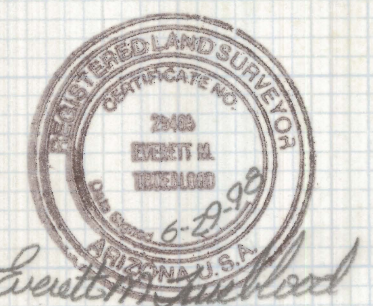

RESULTS OF SURVEY

OF PARCEL 14 OF AYRA VALLEY ESTATES #6 AS RECORDED IN DOCKET # 3735 PAGE 739 THRU 741 ALSO BEING A PART OF THE NORTHEAST QUARTER OF SECTION 35 TOWNSHIP 14 SOUTH, RANGE 11 EAST GILA AND SALT RIVER BASE AND MERIDIAN PIMA COUNTY ARIZONA

FND 2" BRASS PLUG IN CONC E 1/4 COR SEC 35

EVERETT M. TRUEBLOOD
 REGISTERED LAND SURVEYOR
 TUCSON, ARIZONA
 JOB # 98-97