

DISCLAIMER:

This unrecorded Record of Survey was donated to the City of Tucson. The City of Tucson provides this data for your personal use "as is." Additionally, the City of Tucson provides this information with the understanding that it is not guaranteed to be accurate, correct or complete and conclusions drawn from such information are the responsibility of the user.

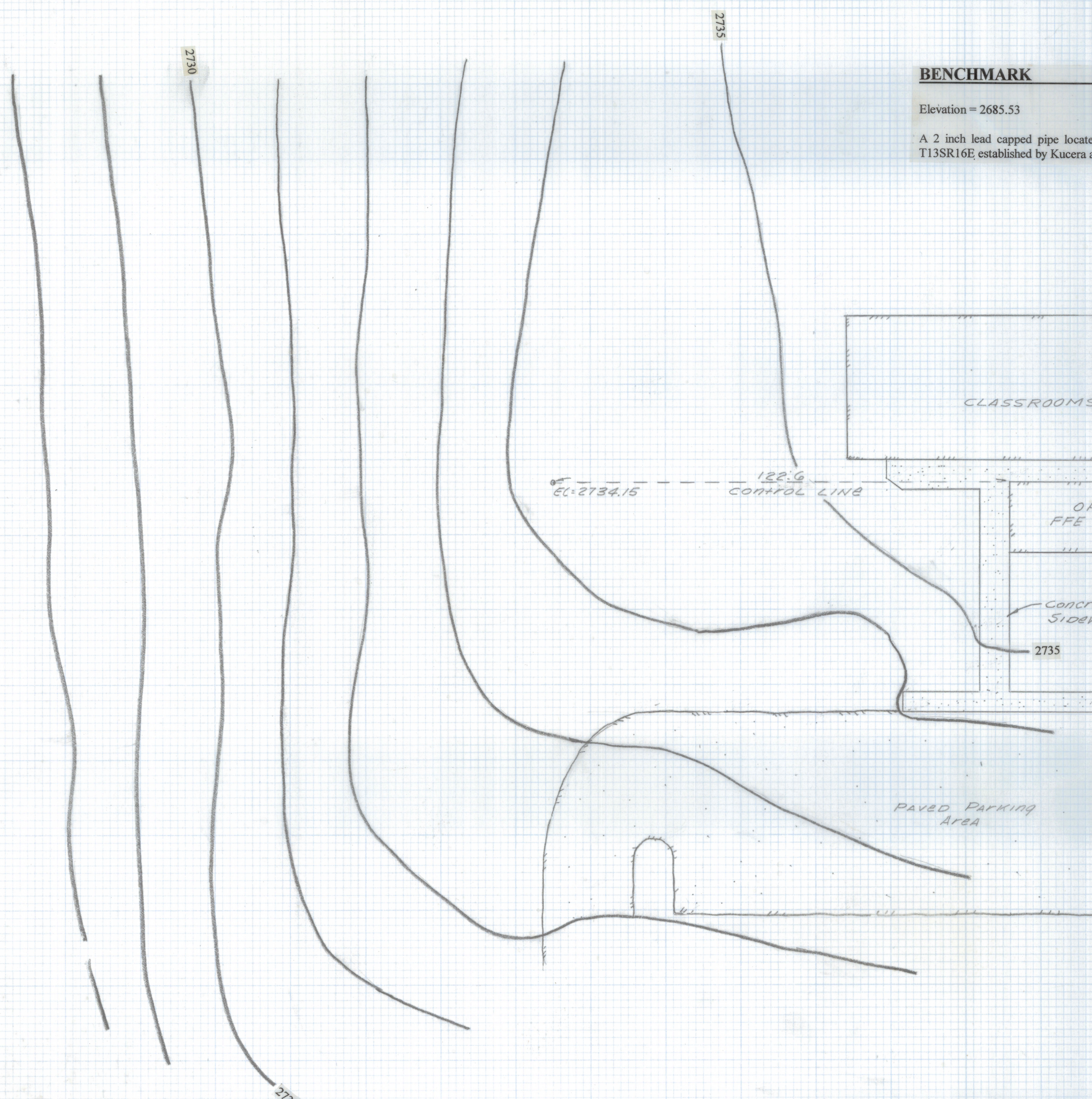

BENCHMARK

Elevation = 2685.53

A 2 inch lead capped pipe located at Prince Road and Soldier Trail ¼ Section corner 29 and 30. T13SR16E established by Kucera and Associates, Inc. recovered by Pima County Survey 12/93.

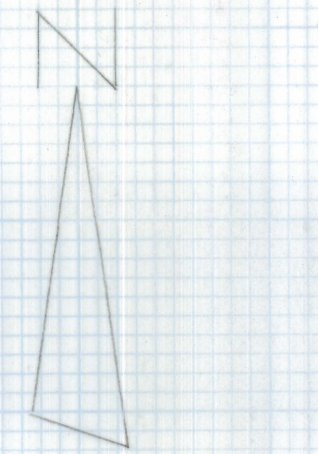

SCALE 1" = 20'
C.I. = 1 Foot

TOPOGRAPHICAL SURVEY OF

A portion of the East half of the Southwest quarter of the Southwest quarter of Section 29, Township 13 South, Range 16 East, Gila and Salt River Base and Meridian, Pima County, Arizona.



DATE		REVISIONS
EVERETT M. TRUEBLOOD LAND SURVEYING 2300 West Ian Place Tucson, AZ 85741 (520) 888-2519		
Drawn By: EMT	Checked By: EMT	Date: September 2, 1998.
Job No. 98-140	Scale: 1" = 20'	Sheet 1 of 1